

Deluxe 8 Homecruiser

location guide

Upstairs

- 2 x life rings (rear roof)
- Man over board light
- BBQ
- **BBQ – Emergency Shut Off**
Gas Cock (under BBQ)
- Gas bottle (under BBQ)

Under Rear Stairs

- Battery Change-over switch
- Batteries
- Gas bottles x 2
- Hot Water System
- Hot Water - Emergency
Shut off Gas Cock

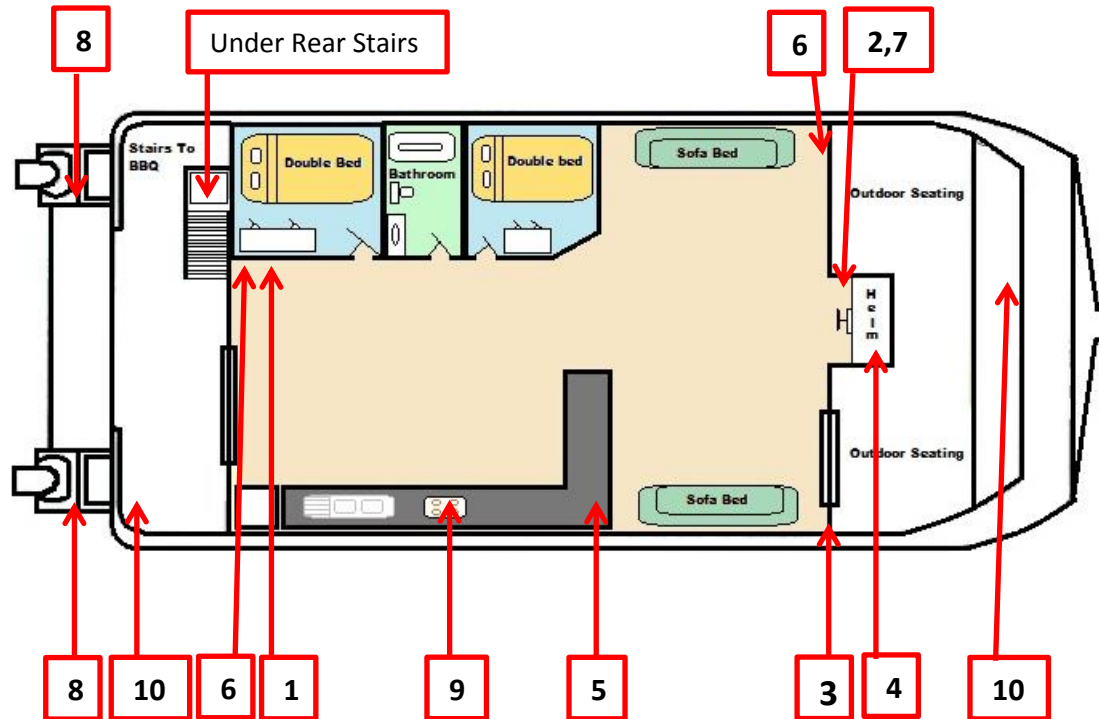

Downstairs

- 1- Main circuit breaker (switch panel)
Water meters
Holding tank meters
- 2- In drawer under driver's bench:
First Aide Kit
Torch
Handbook
Winch handle
- 3- Boat hook (outside – bow of boat)
- 4- Life jackets (under helm)
- 5- Instruction map (on wall)
- 6- Fire Extinguishers x 2 (inside)
- 7- Anchor circuit breaker (helm)
two-way radio (at helm)
- 8- Fuel cocks & fuel bulbs (at motor)
- 9- **Stove/Cook Top – Emergency Shut Off**
Gas Cock (in cupboard next to kitchen sink)
- 10- Deck Wash



Hawkesbury Afloat @ BROOKLYN MARINA

45 Brooklyn Road, BROOKLYN
PH: 9985 7722 Mobile: 0408 102614
Email: relax@brooklynmarina.com.au

September, 2019