



# Hawkesbury Afloat at BROOKLYN

Ph: 9985 7722

## 'NEMO' – 4 person fast Tinnie - 30hp Yamaha (4 stroke)

### STAFF - checklist before starting:

1. Ensure "Hirer" has a first aid kit and is on the correct boat – site contract
2. Ensure fuel hose is connected
3. Check fuel, cap is firmly closed on tank and breather is open & tanks laying flat
4. Squeeze fuel line - pump until firm.
5. Ensure fuel line is not pinched.
6. Check life jacket numbers
7. Check RED cord
8. Check anchor & rope
9. Check fire extinguisher



### Motor Components Diagram

1. Cowling Cover
2. Fuel hose connection
3. Gear and throttle cables
4. Hydraulic steering unit



### How to tilt motor up (at helm):

1. Ensure engine is off
2. Ensure there are no persons in water.
3. Push the black tilt button on throttle lever and motor will lift up



### How to tilt motor up (at motor):

4. Ensure engine is off
5. Ensure there are no persons in water, especially at rear of boat
6. Push the black tilt button on port side of motor (up on rocker switch)

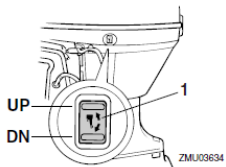

### How to tilt motor down (on motor or helm):

1. Ensure engine is off
2. Ensure there are no persons in water
3. Push the black tilt button on throttle lever or port side of motor and motor will slowly tilt down.

### SAFETY EQUIPMENT

- 4 x life jackets
- 1 x first aid kit
- 1 x bailing container
- 1 x paddle & 1 x torch
- Fire extinguisher
- Emergency stop cord
- Air horn & flare (in kit)



### How to (drop) anchor:

1. Do not anchor under bridges or over sea grass beds or over submerged cables
2. Ensure rope is untangled then drop anchor overboard at bow
3. Wait for tension on rope, allow an extra metre or so of slack
4. Then tie off on the bow of boat

### How to lift anchor:

1. Have motor running & not in gear
2. Untie rope at bow and pull in rope
3. If you cannot pull in anchor because it is stuck you may have to cut the line and lose anchor and bond. OR - try and drive over anchor and this may dislodge the anchor from bottom. But you may risk getting anchor line caught in propeller and lose bond.

### Steering:

1. To steer left - move steering wheel left
2. To steer right - move steering wheel right
3. Speed is controlled by throttle arm

### Tips:

1. Do not reverse motors to slow down/stop
2. When docking and departing ensure all are seated
3. Read do's and don'ts on our Map
4. Avoid fishing fines (have a fishing licence) & don't keep undersized fish
5. If a big boat leaves large waves steer front-on into the waves slowly
6. DO NOT drive boat onto beaches
7. Motors will not start if throttle levers aren't in neutral
8. For turning - turn wheel THEN put into gear
9. Ensure you have your mobile phone with you and it's charged – this number is on our contract.

### How to start motor:

1. Place gear shift in neutral. You know it is neutral position when you can hear a click and red button clicks

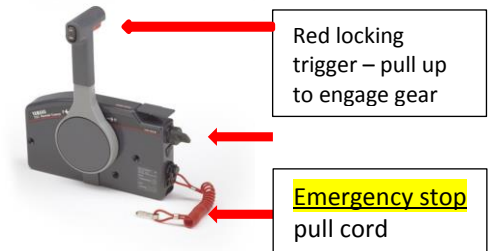

### Ensure no person is in water near motor

2. Turn key quickly clockwise like a car
3. Push red button on throttle arm up and push throttle forward to engage forward gear

### How to stop motor:

1. Place gear shift to neutral position
2. Turn key off (anticlockwise)

### Emergency motor stop:

1. Pull red cord from base

### OIL

- The motor is 4 stroke and oil is not premixed. Staff will keep this topped up.

### Inventory Checklist

- 1 x 30hp outboard
- 1 x fuel tank and line
- 4 x life jackets (in boat)
- 1 x paddle (in boat)
- 1 x anchor & line
- 1 x alu bimini frame with cover
- 1 x bilge pump
- 1 x bailing container (in boat)
- 1 x steering wheel
- 1 x hydraulic steering unit & hoses
- 1 x battery & battery box (in helm)
- 1 x fire extinguisher (in safety kit)
- Instruction signage